

RIVERTOWN PARKWAY

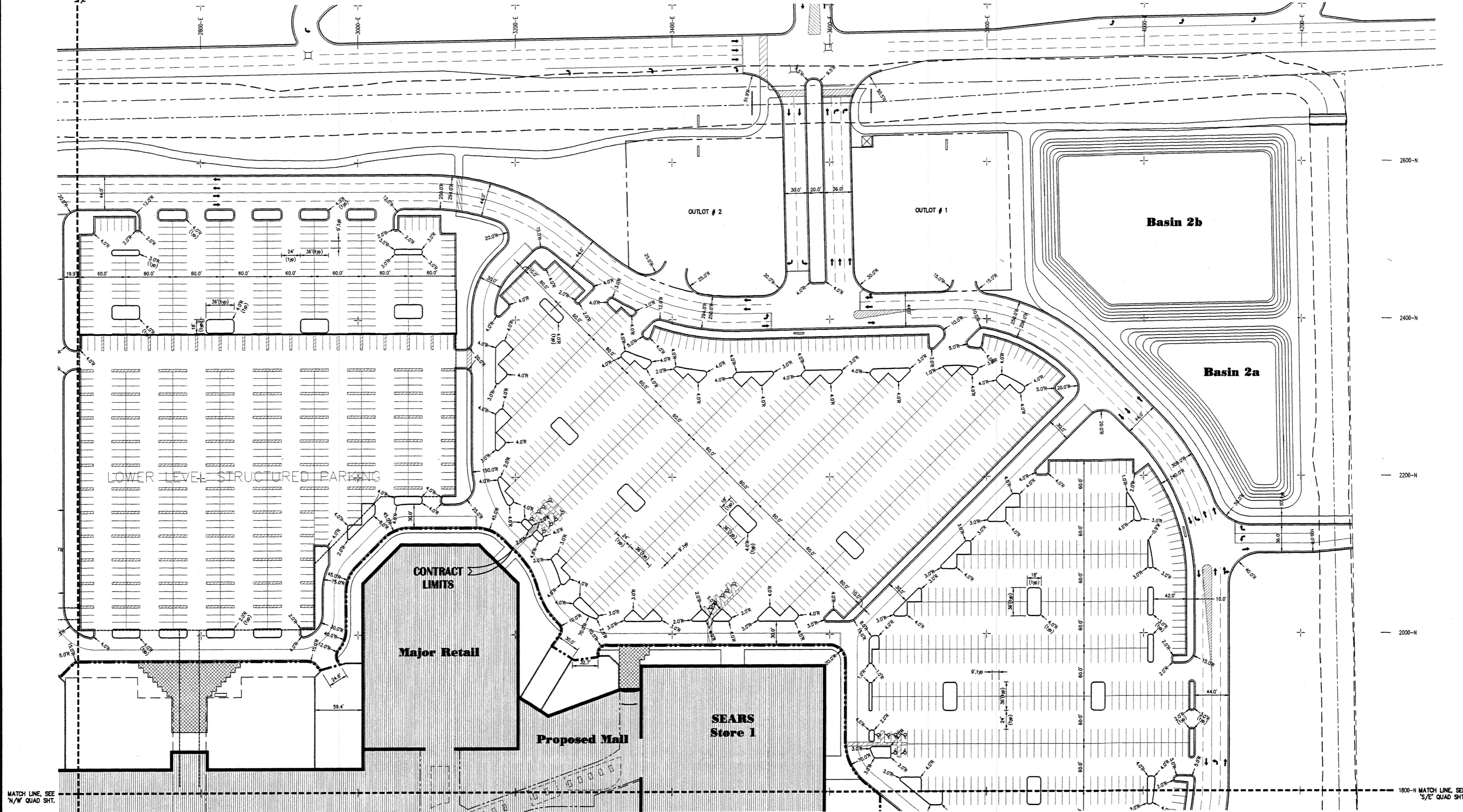

MATCH LINE SEE N/W QUAD SHIT.

MATCH LINE SEE N/W QUAD SHIT.

MATCH LINE SEE S/E QUAD SHIT.

2600-N
2400-N
2200-N
2000-N

1800-N MATCH LINE SEE S/E QUAD SHIT.

NOTES

1. ALL DIMENSIONS SHOWN ARE TO FACE OF CURB AND CENTER OF PAINTED LINES.
2. SITE CONTRACTOR SHALL CONSTRUCT ALL 3" CURETS AROUND THE BUILDING. BUILDING CONTRACTOR WILL CONSTRUCT SIDEWALK FROM BUILDING AND CONNECT TO CURB.
3. PROVIDE CURB CUTS / SIDEWALK RAMPS AT ALL PEDESTRIAN AND BARRIER FREE ACCESS POINTS.
4. SEE PAVING PLAN FOR PAVEMENT CROSS SECTIONS.
5. SEE DETAIL SHEET FOR CURB AND SIDEWALK RAMP DETAILS.

LEGEND

- CONTRACT LIMITS
- M.D.O.T. TYPE 'F4' CURB (SEE DETAIL SHEET)
- M.D.O.T. TYPE 'E4' CURB (SEE DETAIL SHEET)
- RADIUS OF CURB TO FACE OF CURB

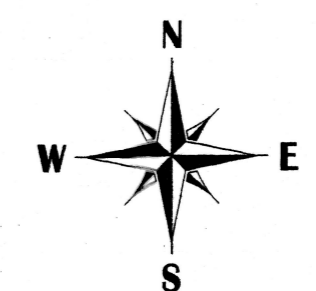

site dimension plan: 'n/e' quad

SCALE: 1" = 50'

1200 Business Park Drive
 Louisville, KY 40240
 502-261-1234
 Fax: 502-261-4033

Gosling Cavahak
 ENGINEERING ARCHITECTS, INC.
 PROFESSIONAL ENGINEERS AND ARCHITECTS

No. _____ Date: _____
 Revision: _____
 Drawn By: T.A.
 Checked By: TDH/DAC
 Date: 2-6-98
 Scale: 1" = 50'

Location: PART OF THE NORTH 1/2 OF SECTION 29, T 6 N, R 12 W, KY COUNTY, MICHIGAN

SITE DIMENSION PLAN
RiverTown Crossings

Project No. 98300.09
 Sheet 14 of 36

ISSUED FOR CONSTRUCTION : 2-6-98